

PIPE CLAMPS

PCS - PIPE CLAMPS(LIGHT SERIES)

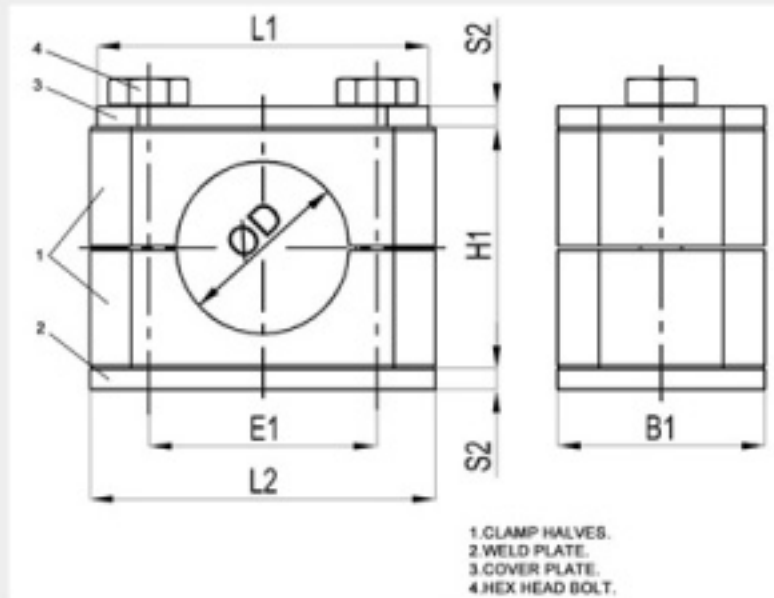

ORIENT ENGINEERING WORKS



| ORDER CODE | GROUP | TUBE OD MM ØD | TUBE NB | TUBE OD INCHES ØD | DIMENSIONS B1 | DIMENSIONS E1 | DIMENSIONS H1 | DIMENSIONS L1 | DIMENSIONS L2 | DIMENSIONS S2 | HEX HEAD BOLT |
|------------|-------|---------------|---------|-------------------|---------------|---------------|---------------|---------------|---------------|---------------|---------------|
| PCS 6 | 1 | 6 | | | 30 | 20 | 27 | 37 | 36 | 3 | M6X30 |
| PCS 6.4 | 1 | 6.4 | | 1/4 | 30 | 20 | 27 | 37 | 36 | 3 | M6X30 |
| PCS 8 | 1 | 8 | | 5/16 | 30 | 20 | 27 | 37 | 36 | 3 | M6X30 |
| PCS 9.5 | 1 | 9.5 | | 3/8 | 30 | 20 | 27 | 37 | 36 | 3 | M6X30 |
| PCS 10 | 1 | 10 | G1/8 | | 30 | 20 | 27 | 37 | 36 | 3 | M6X30 |
| PCS 12 | 1 | 12 | | | 30 | 20 | 27 | 37 | 36 | 3 | M6X30 |
| PCS 12.7 | 2 | 12.7 | | 1/2 | 30 | 26 | 33 | 42 | 42 | 3 | M6X35 |
| PCS 13.5 | 2 | 13.5 | G1/4 | | 30 | 26 | 33 | 42 | 42 | 3 | M6X35 |
| PCS 14 | 2 | 14 | | | 30 | 26 | 33 | 42 | 42 | 3 | M6X35 |
| PCS 15 | 2 | 15 | | | 30 | 26 | 33 | 42 | 42 | 3 | M6X35 |
| PCS 16 | 2 | 16 | | 5/8 | 30 | 26 | 33 | 42 | 42 | 3 | M6X35 |
| PCS 17.2 | 2 | 17.2 | G3/8 | | 30 | 26 | 33 | 42 | 42 | 3 | M6X35 |
| PCS18 | 2 | 18 | | | 30 | 26 | 33 | 42 | 42 | 3 | M6X35 |
| PCS 19 | 3 | 19 | | 3/4 | 30 | 33 | 35 | 50 | 50 | 3 | M6X40 |
| PCS 20 | 3 | 20 | | | 30 | 33 | 35 | 50 | 50 | 3 | M6X40 |
| PCS 21.3 | 3 | 21.3 | G1/2 | | 30 | 33 | 35 | 50 | 50 | 3 | M6X40 |