

INTERNATIONAL FITTINGS

MJ-MBSPP 7002 SERIES

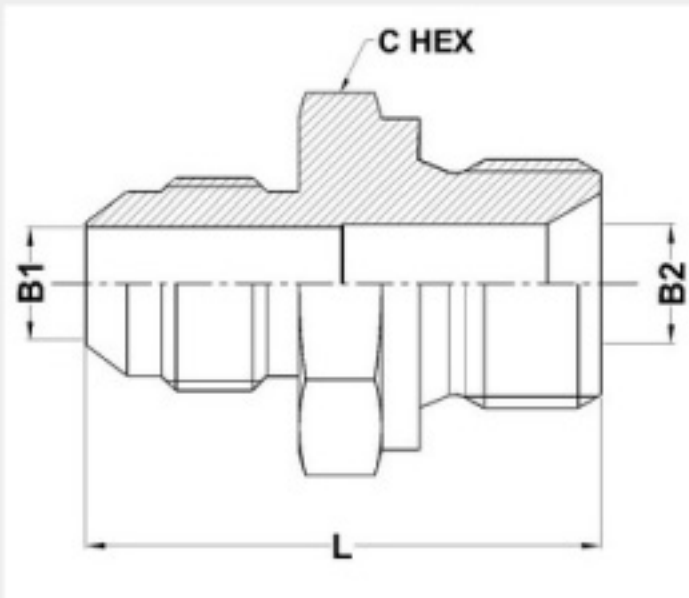

ORIENT ENGINEERING WORKS



PART NO. SIZE	TUBE O.D.	B1 JIC	B2 BSPP	B1 DRILL	B2 DRILL	L LGTH	C HEX
7002-04-02	1/4	7/16-20	1/8-28	4.4	3.5	27.0	14.0
7002-04-04	1/4	7/16-20	1/4-19	4.4	6.3	32.0	19.0
7002-04-06	1/4	7/16-20	3/8-19	4.4	7.9	34.0	22.0
7002-04-04	1/4	7/16-20	1/2-14	4.4	11.1	38.0	27.0
7002-05-02	5/16	1/2-20	1/8-28	6.0	3.5	28.8	14.0
7002-05-04	5/16	1/2-20	1/4-19	6.0	6.3	32.0	19.0
7002-05-06	5/16	1/2-20	3/8-19	6.0	7.9	34.0	22.0
7002-05-08	5/16	1/2-20	1/2-14	6.0	11.1	38.0	27.0
7002-05-12	5/16	1/2-20	3/4-14	6.0	16.7	42.0	32.0
7002-06-02	3/8	9/16-18	1/8-28	7.5	3.5	29.7	17.0
7002-06-04	3/8	9/16-18	1/4-19	7.5	4.7	32.1	19.0
7002-06-06	3/8	9/16-18	3/8-19	7.5	7.9	34.1	22.0
7002-06-08	3/8	9/16-18	1/2-14	7.5	11.1	38.1	27.0
7002-06-10	3/8	9/16-18	5/8-14	7.5	14.3	42.1	30.0