

# INTERNATIONAL FITTINGS

## MJ-FMS LIGHT METRIC 7007-L SERIES

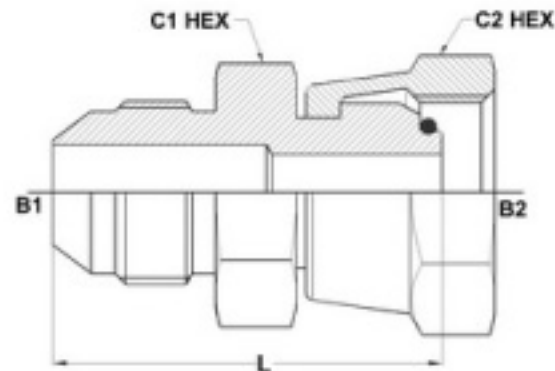

ORIENT ENGINEERING WORKS



PART NO.SIZE	B1 TUBE O.D	B2 TUBE O.D	B1 JIC	B2 MS	B1 DRILL	B2 DRILL	L LGTH	C1 HEX	C2 HEX
7007-04-L06-12	1/4	06	7/16-20	M12 x 1.5	4.4	2.5	37.8	12.0	14.0
7007-05-L06-12	5/16	06	1/2-20	M12 x 1.5	6.0	2.5	37.8	14.0	14.0
7007-06-L08-14	3/8	08	9/16-18	M14 x 1.5	7.5	4.0	39.2	17.0	17.0
7007-06-L10-16	3/8	10	9/16-18	M16 x 1.5	7.5	6.0	41.2	17.0	19.0
7007-06-L12-18	3/8	12	9/16-18	M18 x 1.5	7.5	8.0	39.1	19.0	22.0
7007-06-L15-22	3/8	15	9/16-18	M22 x 1.5	7.5	10.0	39.6	22.0	27.0
7007-08-L10-16	1/2	10	3/4-16	M16 x 1.5	9.9	6.0	43.9	19.0	19.0
7007-08-L12-18	1/2	12	3/4-16	M18 x 1.5	9.9	8.0	43.9	19.0	22.0
7007-08-L15-22	1/2	15	3/4-16	M22 x 1.5	9.9	10.0	42.2	22.0	27.0
7007-08-L18-26	1/2	18	3/4-16	M26 x 1.5	9.9	13.0	43.2	24.0	32.0
7007-10-L12-18	5/8	12	7/8-14	M18 x 1.5	12.3	8.0	48.0	24.0	22.0
7007-10-L15-22	5/8	15	7/8-14	M22 x 1.5	12.3	10.0	50.0	24.0	27.0
7007-12-L18-26	3/4	18	1-1/16-12	M26 x 1.5	15.5	13.0	54.5	27.0	32.0
7007-12-L22-30	3/4	22	1-1/16-12	M30 x 2	15.5	17.0	58.5	27.0	38.0