

## METRIC BITE TYPE FITTINGS

### GE-N - STRAIGHT MALE STUD COUPLING

Taper Male Thread G - NPT

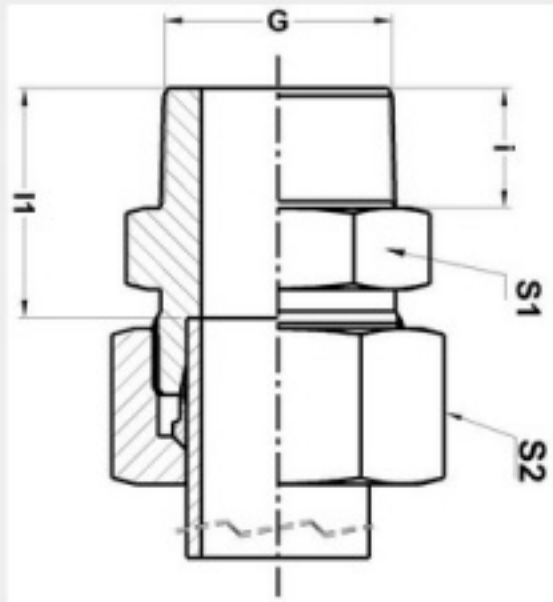

**ORIENT ENGINEERING WORKS**

Part No.	Series	Tube OD	i	l1	S1	S2	G - NPT
GE 06 LN	Light-250 Bar	6	10	18	12	14	G 1/8-27
GE 06 LN	Light-250 Bar	6	15.1	23	17	14	G 1/4-18
GE 08 LN	Light-250 Bar	8	15.1	23	14	17	G 1/4-18
GE 10 LN	Light-250 Bar	10	15.1	24	14	19	G 1/4-18
GE 10 LN	Light-250 Bar	10	15.1	24	19	19	G 3/8-18
GE 12 LN	Light-250 Bar	12	15.1	25	19	22	G 1/4-18
GE 12 LN	Light-250 Bar	12	19.98	25	19	22	G 3/8-18
GE 12 LN	Light-250 Bar	12	19.98	30	22	22	G 1/2-14
GE 15 LN	Light-250 Bar	15	19.8	31	24	27	G 1/2-14
GE 18 LN	Light-160 Bar	18	19.8	31.5	27	32	G 1/2-14
GE 22 LN	Light-160 Bar	22	20.5	33.5	32	36	G 3/4-14
GE 28 LN	Light-100 Bar	28	25	39.5	41	41	G 1-11.5
GE 35 LN	Light-100 Bar	35	26	40.5	46	50	G 1.1/4-11.5
GE 42 LN	Light-100 Bar	42	26	42	55	60	G 1.1/2-11.5
GE 06 SN	Heavy-630 Bar	6	15.1	26	17	17	G 1/4-18